

VICTORY[®]

ULTRASPEC

PROJECT: _____

ITEM # _____ QTY: _____

MODEL # _____

AIA # _____ SIS # _____

ROLL-THRU EXTRA TALL GLASS DOOR REFRIGERATOR

ROLL-THRU EXTRA TALL GLASS DOOR REFRIGERATOR

RISA-1D-S1-PT-XH-G-HC



EXCLUSIVE WARRANTY

- ▶ 7 Year Parts, Labor and Compressor
- ▶ Exclusive 2 Year Warranty On Magnetic Door Gaskets
- ▶ Lifetime Warranty On Handles & Hinges (parts only)

CABINET CONSTRUCTION

- Stainless Steel Exterior
- Aluminum Interior
- Aluminum Interior
- Heavy-Duty Cam Hinges
- Stay-Open Door Feature For Easy Product Loading
- Glass Door
- Heavy-Duty Cylinder Locks
- Adjustable Door Wiper Gasket
- One-Piece, Snap-In Magnetic Door Gasket
- Low Profile Vertical Door Handles
- Hinged Front Shroud
- Energy Saving Thermal Breaker With Stainless Steel Breaker Caps
- Accepts Cart: 26 1/2"W x 28"D x 71 1/2"H (cart not included)
- 8' Cord And Plug (see electrical data for details)

FEATURES

- Full Electronic Control With Touchpoint Interface
- Expansion Valve Technology
- One Touch Defrost
- Manager's Lockout Feature
- High Performance, Balanced, Top-Mounted Refrigeration
- Anti-Condensate Perimeter Heater

REFRIGERATION

- Refrigeration System Uses R-290 Refrigerant To Comply With All Environmental Concerns
- Hot Gas Condensate Evaporator
- Adaptive Defrost For Reduced Energy Consumption And More Consistent Product Temperatures
- Epoxy Coated Evaporator Coil, Located Out Of The Food Zone
- Refrigerator Capable Of Maintaining Product Temperature 36°F To 38°F



Please Verify Qualifying Units By Visiting:
www.energystar.gov/cfs

OPTIONS & ACCESSORIES

- Stainless Steel Back
- FlexTemp Maintain Between 28°F And 38°F
- Stainless Steel Exterior Floor (base)
- Door Swing Orientation (at time of order)

3779 Champion Blvd, Winston-Salem, NC 27105

ph: (888) 845-9800 | fax: (800) 253-5168

Sales@VictoryRefrigeration.com | VictoryRefrigeration.com

Rev. 3/12/26 Printed in U.S.A.

APPROVAL: _____ DATE: _____

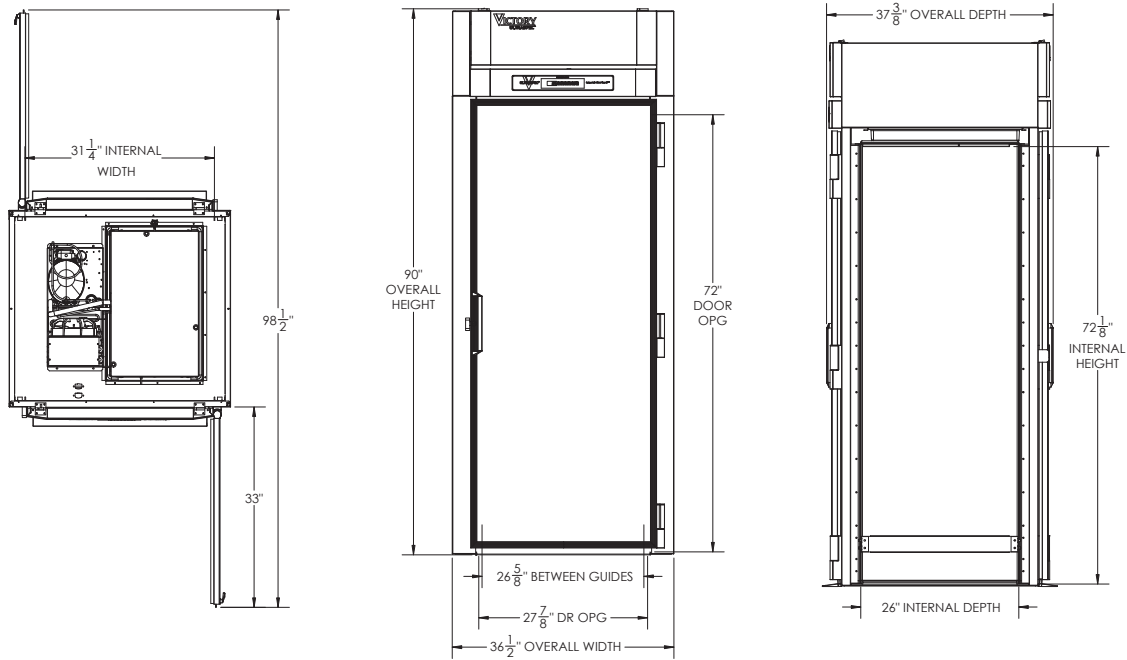

We reserve the right to change specifications and product design without notice. Such revisions do not entitle the buyer to corresponding changes, improvements, additions or replacements for previously purchased equipment. Dimensional tolerances +/- 1/4". Metric dimensions (MM)

12" Top clearance is required

CHARACTERISTICS		ELECTRICAL DATA		SHIPPING DETAILS	
Net Capacity (cubic ft.)	42.27	Cabinet Voltage*	115/60/1	Height	95"
Width, Overall (in.)	36 1/2"	Total Amperes	8.5	Width	45"
Depth, Overall (with handle)	37 3/8"	NEMA Plug (8" cord)	5-15P	Depth	45"
Height Overall (in.)	90"	REFRIGERATION DATA		Crated Weight	560 lbs
Depth, Door Open 90°	98 1/2"	Condensing Unit Size, HP	3/4		
Door Openings (in.)	27 7/8" x 72"	Refrigerant	R-290		
No. Of Doors	2	Capacity (BTU/HR) (100°F/20°F)	4950		
		Heat Rejection (BTU/HR)	7425		
		Charge (lbs/grams/ounces)	0.2866 / 130 / 4.59		

* NOTE: This unit utilizes variable speed compressor technology. The compressor can experience nuisance tripping on Class A GFCI outlets which have a trip limit of 4 mA to 6 mA. To avoid this issue in a location that requires GFCI circuit protection, Victory recommends using either an Eaton, SGF20, or HUBBELL Model Number GFRST83W 20A Heavy Duty Hospital Grade Self-Test GFCI Receptacle.

3779 Champion Blvd, Winston-Salem, NC 27105 | ph: (888) 845-9800 | fax: (800) 253-5168

Sales@VictoryRefrigeration.com | VictoryRefrigeration.com

Rev. 3/12/26 Printed in U.S.A.